

RENTING @ AED1.25M PER ANNUM
Amazing Sea View | Upgraded | Vacant Now



**This property is subject to availability and the price is subject to change. Size may be approximate and images may be generic.*

RESIDENTIAL FOR RENT

Type	Apartment	Built-up Area	2,034 sqft
Location	Bluewaters	Bedrooms	3 Bed
Property	Bluewaters Residences, Apartment Building 4	Bathrooms	4 Bath
RERA Permit	7148959346	Parking	2 Car Park
Agency Fee	AED62.5K	Security Deposit	AED125K
Entered Date	Aug 3, 2024 02:46 pm	Updated Date	Aug 3, 2024 02:46 pm

Ref#:GMR-17244



WILL TAYLOR
Client Manager
BRN 61750



wt@goldmark.ae

+971 54 888 0064



Gold Mark Real Estate is proud to bring to the market this stunning, beautifully upgraded, and tranquil apartment with breathtaking sea views. This fully furnished property has recently undergone a complete high-end modern renovation. Viewing is highly advised.

Property Details:

- Gorgeous sea and sunset views
- Fully upgraded to luxury standards
- Maid's room
- Fully furnished
- Sea views from all rooms

Bluewaters is a destination with a pioneering spirit, blending waterfront living with the exhilaration of the city to create an unrivaled experience for residents and visitors. Located off the coast of JBR opposite The Beach, it is home to Ain Dubai, the world's largest observation wheel, and the first Caesars Palace hotels in the Middle East. With a range of other exciting attractions, this lively, family-oriented neighborhood is set to become one of the world's largest tourism hotspots, featuring distinctive retail, hospitality, and entertainment options that will leave all who visit spoilt for choice.

For viewings and additional information, contact Will Taylor at **+971 54 888 0064** or email wt@goldmark.ae. Visit www.goldmark.ae.

With extensive experience in Dubai's real estate market, Gold Mark Real Estate helps clients secure and rent properties across all areas of Dubai.



WILL TAYLOR
Client Manager
BRN 61750



wt@goldmark.ae

+971 54 888 0064

3 Bedroom Apartment Type 3-1

Levels 2 to 7

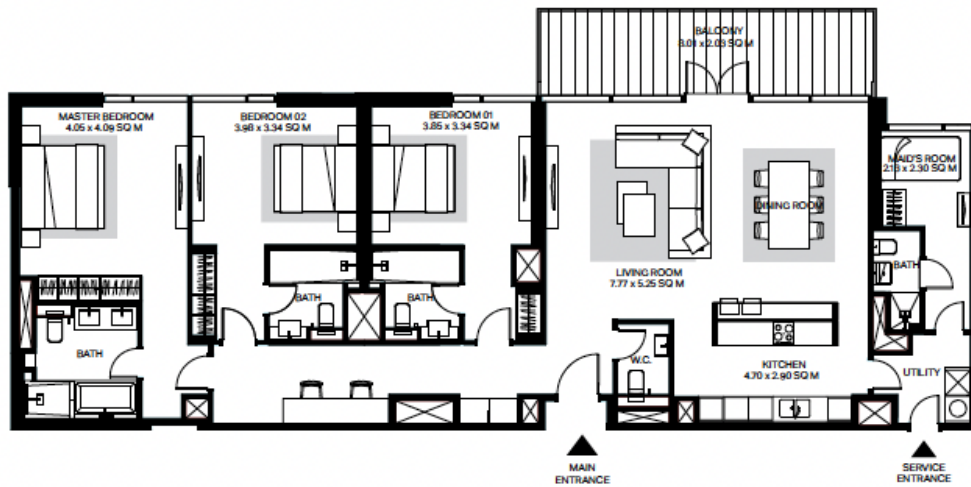

Floor shape

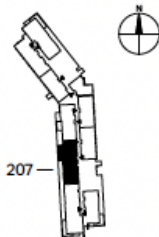

Units 207, 308, 408, 508, 608, 708

Net area: 1,868 Sq. Ft.
Balcony area: 177 Sq. Ft.
Total area: 2,045 Sq. Ft.
Parking bay: 2
Views: Garden, Seaview

All dimensions are in imperial and metric, and measured to structural elements and exclude wall finishes and construction tolerances. 2. All materials, dimensions, and drawings are approximate only. 3. Information is subject to change without notice, at the developer's absolute discretion. 4. Actual area may vary from the stated area. 5. Drawings not to scale. 6. All images used are for illustrative purposes only and do not represent the actual size, features, specifications, fittings, and furnishings. 7. The developer reserves the right to make revisions/alterations, at its absolute discretion, without any liability whatsoever.

31



WILL TAYLOR
Client Manager
BRN 61750



wt@goldmark.ae

+971 54 888 0064



WILL TAYLOR
Client Manager
BRN 61750

 wt@goldmark.ae
+971 54 888 0064